

# CARACTERÍSTICAS

MATERIAL	Abeto laminado FSC® Protegida antigraffiti HLG	MATERIAL	Laminated spruce FSC® Protected anti-graffiti HLG
SOPORTES	Chapas de acero Pintura en polvo poliéster color gris acero	SUPPORT	Steel plates Powder polyester paint steel grey color
COLOC.	Anclado con tacos	FIXING	Anchored with bolts
PESO	Por módulos	WEIGHT	By units

DISEÑO / DESIGN *Josep Muxart + Enric Pericas*

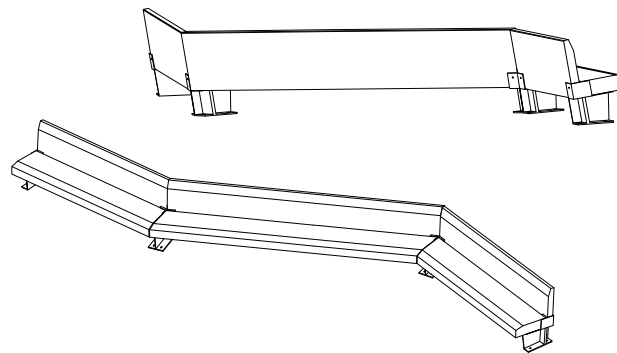

Colección DAE / SUMO ®

## SISTEMA DE COLOCACIÓN

Taladrar el pavimento Ø 10

Drill pavement Ø 10

Colocar los 4 tacos FISCHER SXR 10X80 FUS  
Put the 4 stud bolts FISCHER SXR 10X80 FUS  
centrar, colocar el banco y rejuntar la zona de apoyo  
Centre and caulk the bench foot all around

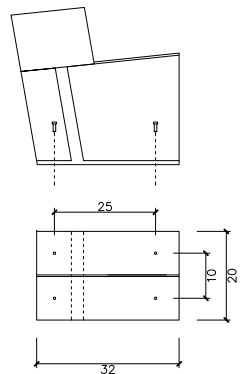

RECTO

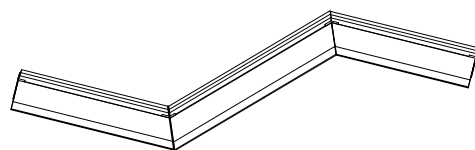

AGREGACIÓN

## GEOMETRÍA

### DESARROLLO BANCO DOBLE RECTO

VARIABLE

300/600

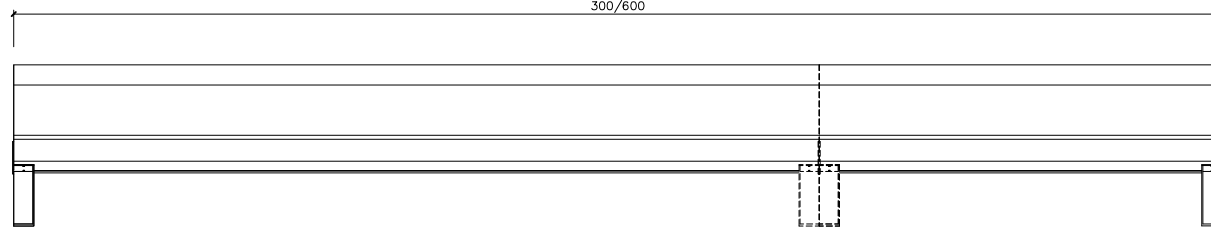

ALZADO FRONTAL

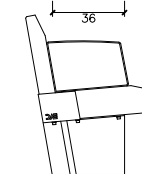
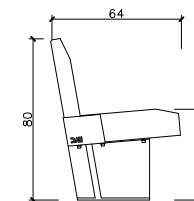

APOYABRAZO / ARMREST

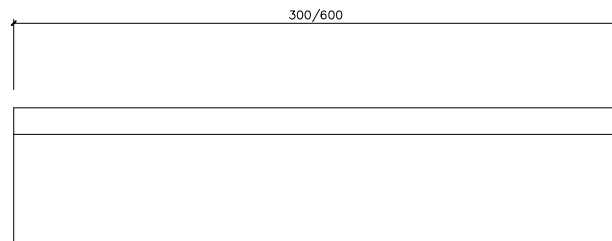

RESPALDOS



SOPORTES

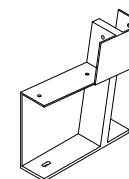

DERECHO

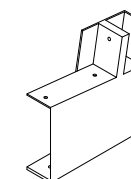

IZQUIERDO

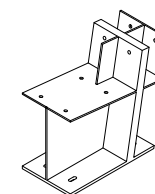

DOBLE

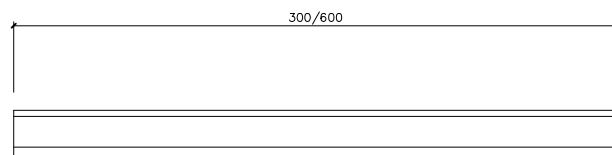

ASIENTOS

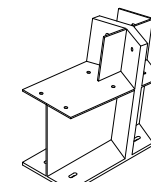
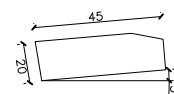

DOBLE CÓNCAVO

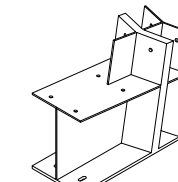

DOBLE CONVEXO