

# CARACTERÍSTICAS

MATERIAL hormigón armado  
 COLOR beige  
 ACABADO decapado suave  
 COLOCACIÓN apoyado sin anclaje (A)  
 anclado con tornillos (B y C)  
 PESO 3000 kg / 1500 kg

MATERIAL reinforced cast stone  
 COLOUR beige  
 FINISH soft acid-treated  
 FIXING free-standing (A)  
 anchored with screws (B and C)  
 WEIGHT 3000 kg / 1500 kg

DISEÑO / DESIGN Enric Miralles / Benedetta Tagliabue



LUNGOMARE®

# SISTEMA DE COLOCACION

ESCALA 0 CM 100 CM

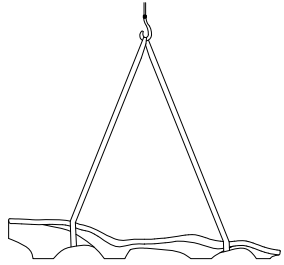

MODULO A APOYADO SIN ANCLAJE  
 FREE-STANDING A MODULE

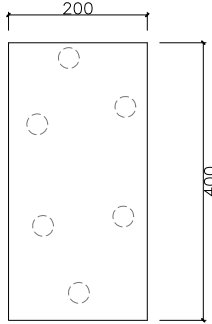

MODULO A

- Roscar los 3 tornillos a fondo M-16x140
- Tightly screw the 3 stud bolts M-16x140
- Taladrar el pavimento (Ø20x180) y llenar con resina o mortero rico
- Drill pavement (Ø20x180) and fill with resin or fat mortar
- Centrar y colocar
- Centre and caulk

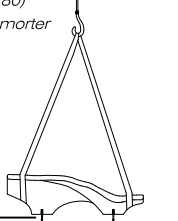

M-16x140  
 Ø20x180

MODULOS B y C ANCLADOS  
 ANCHORED B and C MODULES

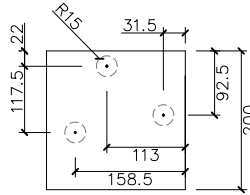

MODULO B

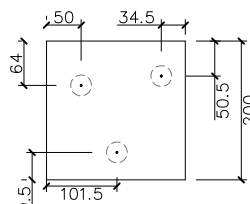

MODULO C

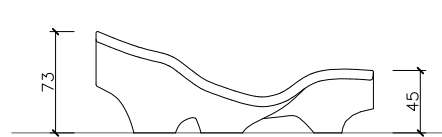

ALZADO c



ALZADO d

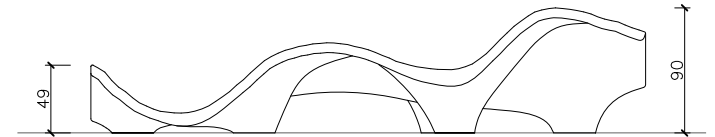

ALZADO a



ALZADO b

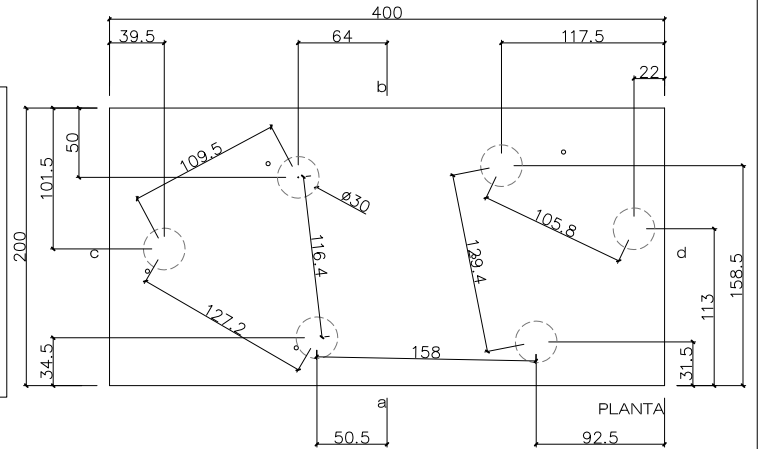

PLANTA

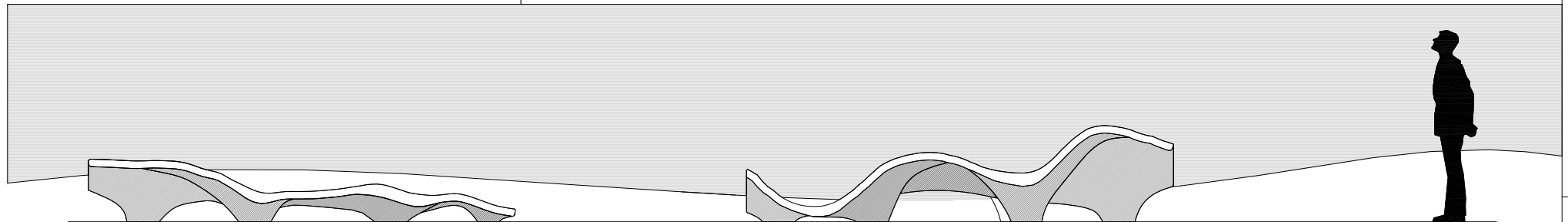

www.escofet.com

escofet