

## CARACTERÍSTICAS

MATERIAL hormigón  
semiseco prensado  
COLOR ocras  
ACABADO salido de molde  
COLOCACION sobre lecho de arena  
PESO 39 kg / 120 kg  
PALET 100x75  
30 uds.pequeñas- 1170kg  
6 uds.grandes- 720kg

MATERIAL *semidry pressed  
cast stone*  
COLOUR *ochers*  
FINISH *as it leaves the mould*  
FIXING *over a bed of sand*  
WEIGHT *39 kg / 120 kg*  
PALLET *100x75*  
30 units.small- 1170kg  
6 units.big- 720kg

DISEÑO / DESIGN Enric Miralles  
Benedetta Tagliabue

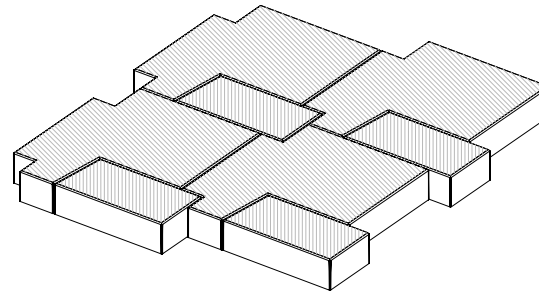

ADA®

## COLOCACION

## GEOMETRIA

ESCALA 0 MM 200 MM

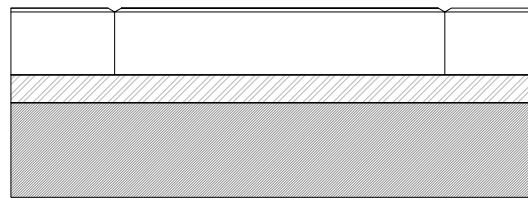

ADA (12cm)  
arena / sand 4cm-6cm  
tierra compactada  
u hormigón (H-200)  
compacted soil  
or concrete (H-200)

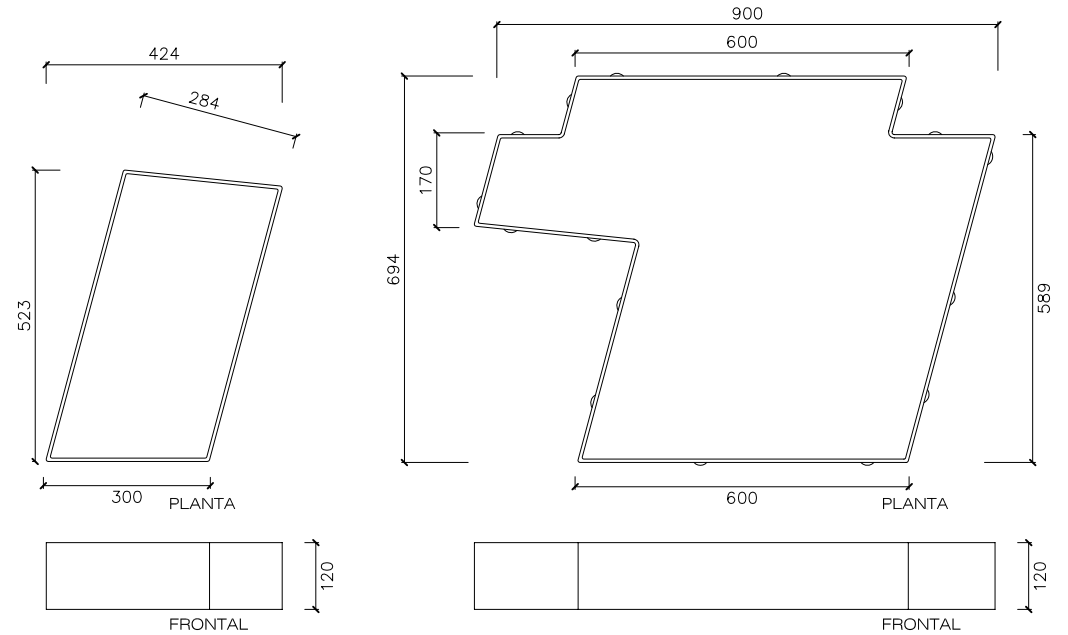

## AGREGACION

