





Twig Plastic is a backless bench system that embodies the concepts of modularity, fluidity, connection and interactivity with its users. Its organic formation, based on a single model with three arms, allows for the creation of indoor and outdoor “conversational landscapes”, or can be combined with the concrete *Twigs*. The plastic version is highlighted due to its lightness -weighing only 60 kg- and the possibility of incorporating a LED lighting kit.

Polyethylene HDPE |  237 cm |  60 kg |  6

Add-ons: LED

 Update 22.04.2021



Origin

It is a remake of the original model designed for the campus of the Southbank Institute of Technology in Brisbane, Australia.

Modular

The corners of its three arms have the same geometry and cross-section, thus favouring the aggregation of parts in an organic, free and even arbitrary manner. This gives rise to the generation of different compositions and the combination of concrete and plastic modules.

Recycled and recyclable

Product made from a percentage of recycled material, variable according to color. It is monomaterial, which facilitates its recycling, and consequently it is an environmentally sustainable product.

Non-porous

The peculiarity of non-porous HDPE material means that its surface is easy to wash with pressurised water and a degreasing detergent that contains surfactants. It is disinfected with a hydro-alcoholic solution.

Material

Made with rotational-moulded white translucent or standard color chart high polyethylene resins (HDPE). With a threaded inspection chamber cover permitting access to the interior.

Installation

Can be installed on the paving, and anchored, if required, using two optional stainless steel trim systems: fixed and invisible, or exposed and detachable. Its rounded ends permit the installation of continuity modules, with no specific requirements in terms of precision.



TWIG PLASTIC



Escofet®

1. Backless bench

Twig Plastic

Dimensions237 x 193 x 46 cm

Weight60 kg

Lighting3 LED profiles, 32w white colour t°5000k

1.1 General features

MaterialPolyethylene HDPEFixingFree-standing / Anchored

FinishMicro-textured

Flame retardantAvailable with flame retardant treatment, according to UL 94 Classification V0. Color may vary due to additives.

Colours



BLN. White

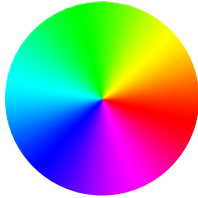

Colort chart standard

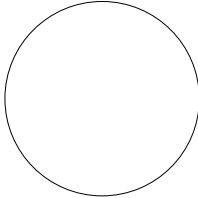

Optional color according to project

1.2 Installation system

Hoisting
(W=60 kg)

Installation
Optional sand ballast to increase the weight.
2.1. Seen and Removable. Drill the pavement and place the staples using expandable blocks. Position and fix using Spax 8x40 screws.
2.2. Hidden and Fixed Drill the pavement and fill with resin or rich mortar.

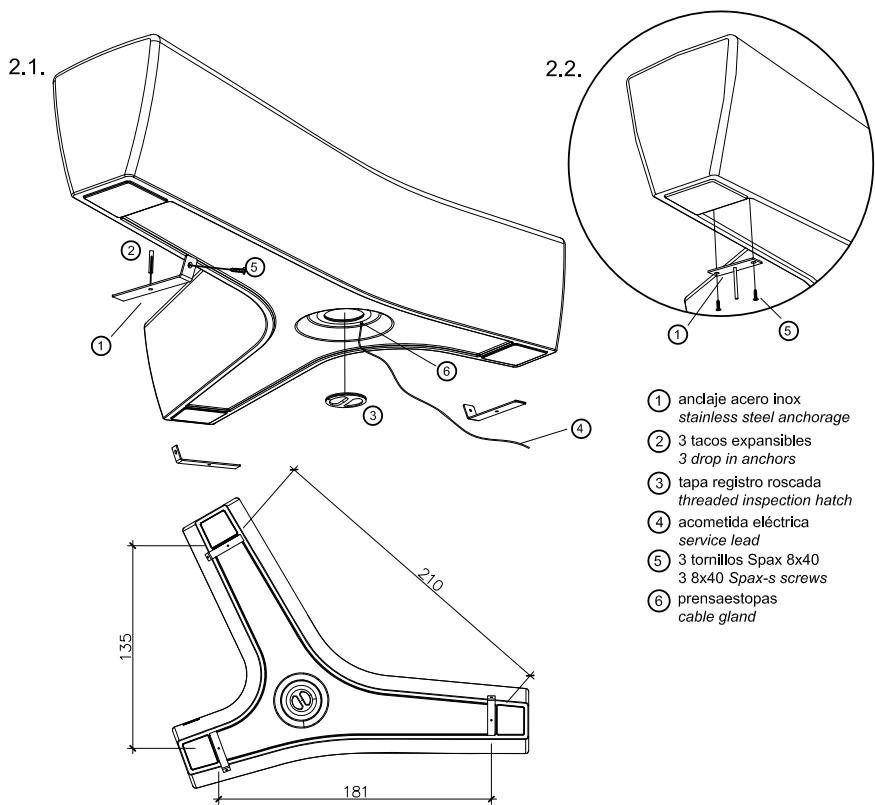

Twig Plastic

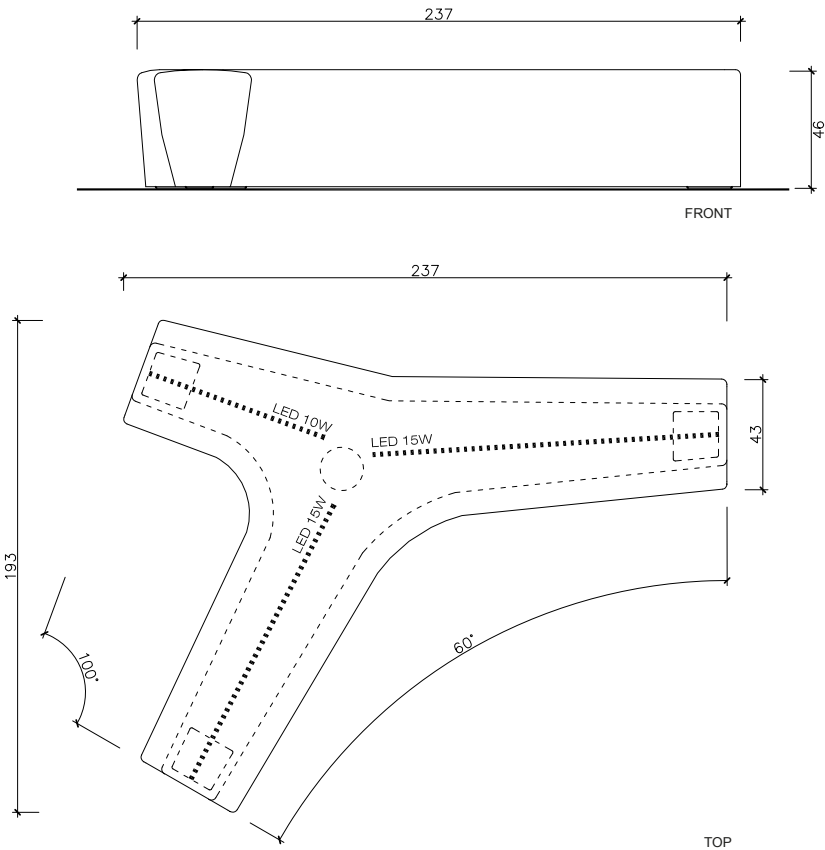

Agreggation

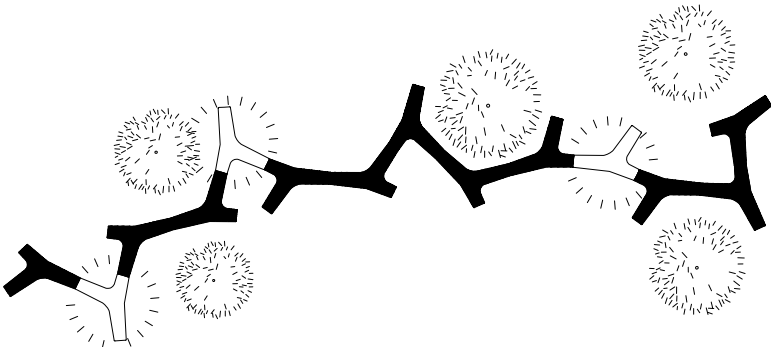



The names, trademarks and industrial models of the products have been logged in the corresponding registers. The technical information provided by Escofet about its products can be modified without prior notice.

Escofet 1886 S.A
Head office and production

Montserrat, 162
E 08760 Martorell
Barcelona - España
T. 0034 937 737 150
F. 0034 937 737 151

info@escofet.com
www.escofet.com



GA-2005/0072 SST-0090/2010 ER-0403/2016