

*Stul* is a functional stool for sitting on or that inspires jumping games. It is ideal for green areas and children's playgrounds. It can also be used as a pylon with a swivel seat on private terraces or in indoor areas such as libraries or other institutions. It stands out for its lightness and wide color palette.

Polyethylene HDPE | Ø 60 cm | 12 kg | 1

Update 22.02.2022



**Origin**

*Stul* apperars to fill the need for a lightweight stool that can be combined with the rest of Air Collection.

**Modular**

*Stul* is a versatile stool and can be installed in multiple contexts. As a stool around a table, combined in groupings and even as a seat in children's play areas.

**Recycled and recyclable**

It is monomaterial and 100% recyclable. The option in black color is 100% recycled, and consequently it is an environmentally sustainable product.

**Non-porous**

The peculiarity of non-porous HDPE material means that its surface is easy to wash with pressurised water and a degreasing detergent that contains surfactants. It is disinfected with a hydro-alcoholic solution.

**Material**

Made with rotomolded HDPE polyethylene, it's available in a wide variety of colors. With a threaded inspection chamber cover permitting access to the interior.

**Installation**

Can be installed on the paving, and anchored, if required, using a hidden and removable system of screws recessed in the paving.





STUL



**Iscofet**  
®



STUL



**Iscofet**  
®



STUL



Escofet®

STUL



**Escofet**  
®



STUŁ



**Escofet**<sup>®</sup>

1. Stool

Stul
------

Dimensions	Ø60 x 52 cm
------------	-------------

Weight	12 kg
--------	-------



1.1 General features

Material	Polyethylene HDPE	Fixing	Free-standing / Anchored
----------	-------------------	--------	--------------------------

Finish	Smooth texture	Performance	UV resistance and outdoors
--------	----------------	-------------	----------------------------

Flame retardant	Complies with the regulations euroclasses UNE-EN 13501-1:2019, classified as “E” in relation to its reaction to fire behavior.
-----------------	--

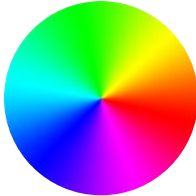
Colours



RBN. White

RNG. Black  
100% recycled

Color chart  
standard \*

\* Optional colour according to project

1.2 Installation system

Hoisting  
(W=12 kg)

Installation

- 1. Indoor: free-standing
  - 2. Outdoor: Hidden and Removable anchored: Drill pavement, fill with resin or fat mortar and place the 3 screws M6. Place the bench, screw 3 side fasteners M5.
- Optionally, to gain weight, the customer can ballast it with sand.

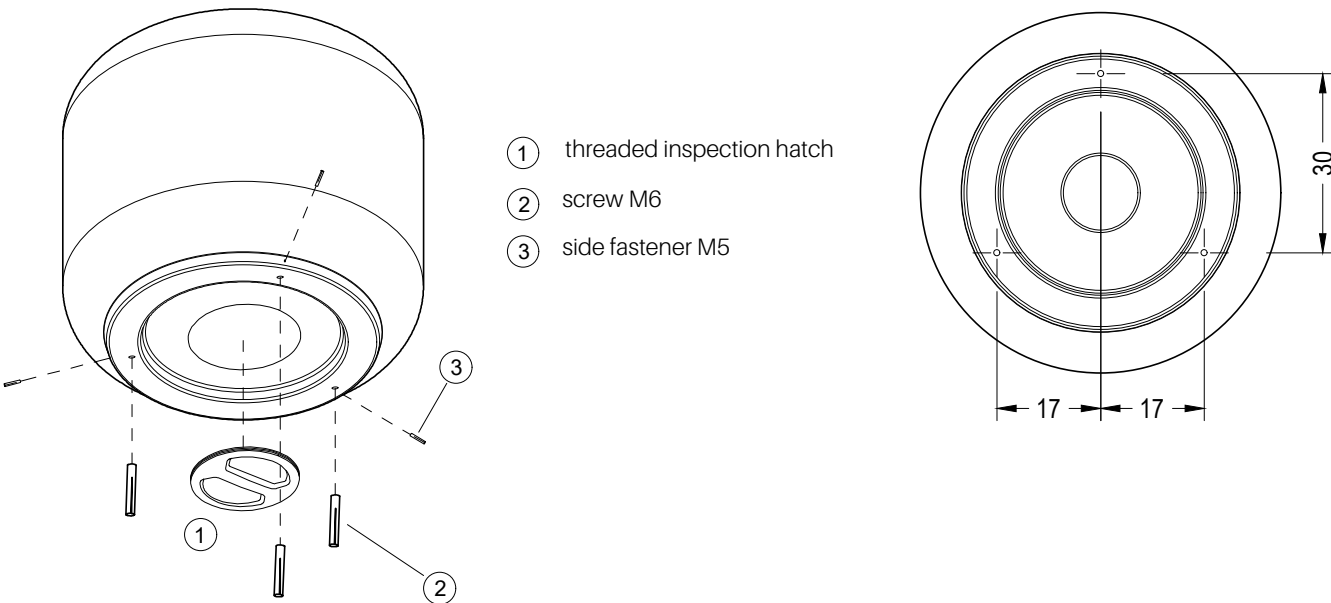



Stul

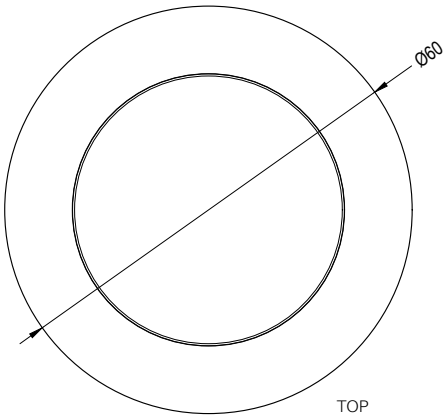
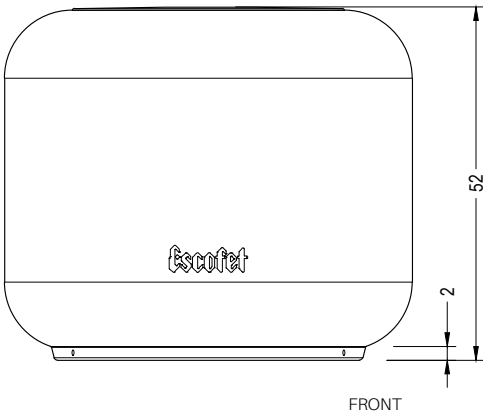

Agreggation

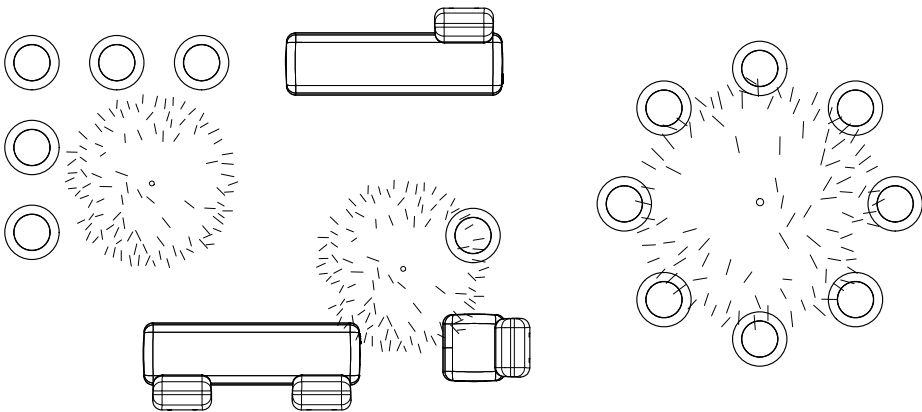



The names, trademarks and industrial models of the products have been logged in the corresponding registers. The technical information provided by Escofet about its products can be modified without prior notice.

Escofet 1886 S.A  
Head office and production

Montserrat, 162  
E 08760 Martorell  
Barcelona - España  
T. 0034 937 737 150  
F. 0034 937 737 151

info@escofet.com  
www.escofet.com



GA-2005/0072 SST-0090/2010 ER-0403/2016

