

CARACTERÍSTICAS / CHARACTERISTICS

MATERIAL madera tropical certificada FSC®
ACABADO tratado con aceite translúcido
SOPORTES acero zincado / acero inoxidable
ACABADO pintado plata texturizado / granallado
COLOC. anclado con tacos de expansión
PESO banco acc. 44kg / silla acc. 20kg
 banca acc. 22kg / asiento acc. 9kg

MATERIAL tropical wood FSC® certified
FINISH treated with translucent oil
SUPPORTS zinc plated steel / stainless steel
FINISH textured silver coated / shotblasted
FIXING anchored with expansion bolts
WEIGHT bench acc. 44kg / chair acc. 20kg
 backless bench acc. 28kg / seat acc. 9kg

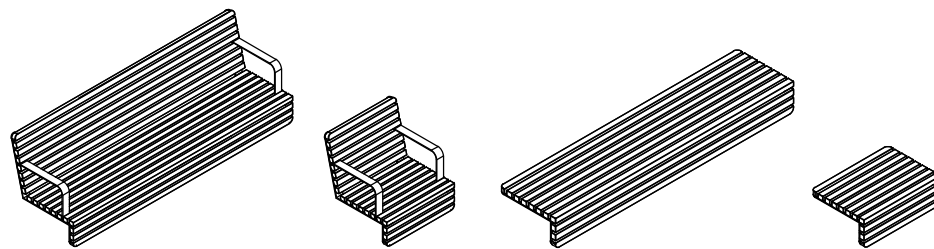

Update 22/11/2022
 Cotas / Sizes cm

INSTALACIÓN / INSTALLATION

Centrar y colocar el accesorio sobre el banco o muro y marcar agujeros colisos
 Center and place the accessory on the bench or retaining wall and mark the slotted holes

E:1/20

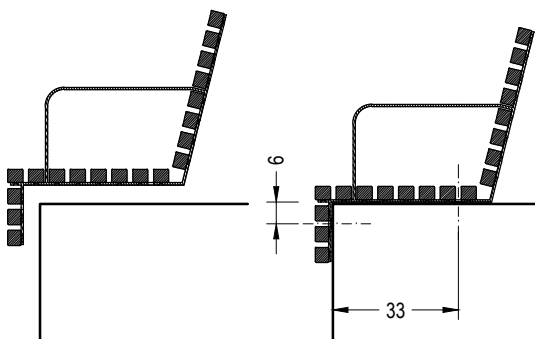

Taladrar el banco o muro y situar el accesorio
 Drill bench or retaining wall and place the accessory

E:1/40

Insertar y rosacar los 4 o 6 tacos de expansión 6 x 45mm
 Insert and tighten 4 or 6 expansion bolts 6 x 45mm

Incorpora arandelas de nylon para separar la madera del soporte
 Includes nylon washers to separate the wood from the support



GEOMETRÍA / GEOMETRY

UNIVERSE-ACC. banco / bench

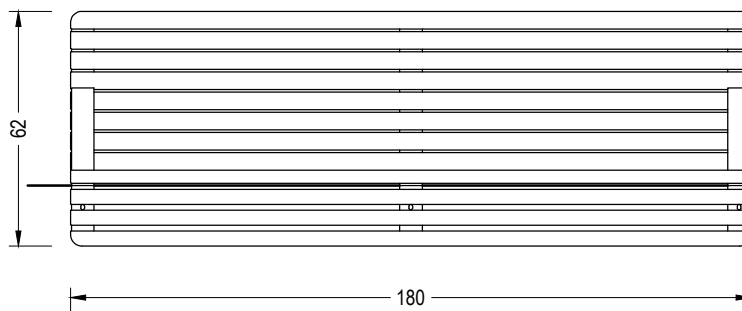
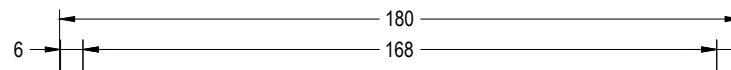

UNIVERSE-ACC silla / chair

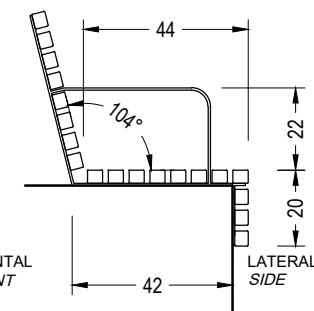
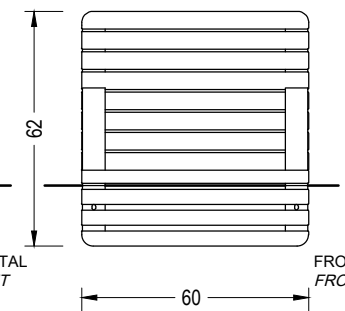
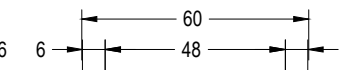

E:1/20

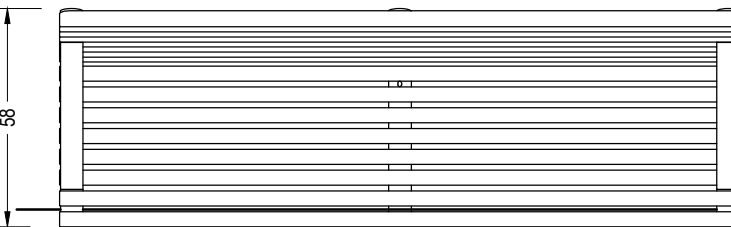

UNIVERSE-ACC banca / backless bench

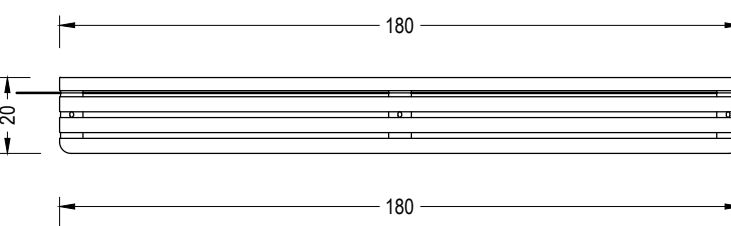

UNIVERSE-ACC asiento / seat

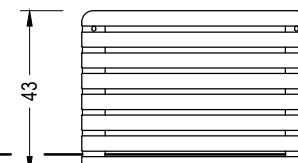
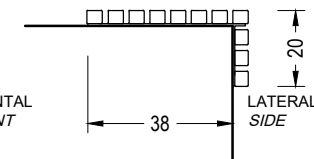
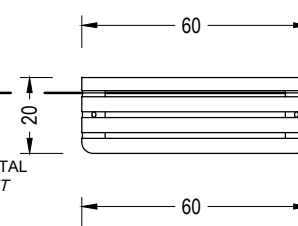

CARACTERÍSTICAS / CHARACTERISTICS

MATERIAL madera tropical certificada FSC®
ACABADO tratado con aceite translúcido
SOPORTES acero zincado / acero inoxidable
ACABADO pintado plata texturizado / granallado
COLOC. anclado con tornillos
PESO banco 60 kg / silla 30 kg
 banca 34 kg / taburete 17 kg
 chaise longue 60 kg / mesa 60 kg

MATERIAL tropical wood FSC® certified
FINISH treated with translucent oil
SUPPORTS zinc plated steel / stainless steel
FINISH textured silver coated / shotblasted
FIXING anchored with screws
WEIGHT bench 60 kg / chair 30 kg
 backless bench 34 kg / stool 17 kg
 chaise longue 60 kg / table 60 kg

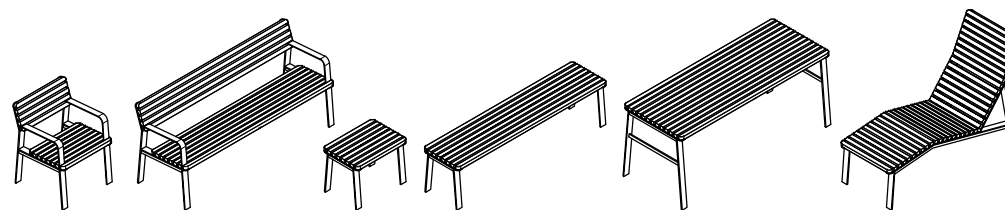

Update 21/09/2022
 Cotas / Sizes cm

INSTALACIÓN / INSTALLATION

elevación / hoisting
 P = 57 kg / 30 kg

eslingas de poliéster
 polyester slings

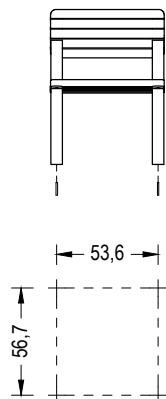

roscar 4 tornillos a fondo DIN 913 M6 x 100
 tightly screw 4 stud bolts DIN 913 M6 x 100

taladrar el pavimento Ø12 mm y llenar con resina
 drill pavement Ø12 mm and fill with resin

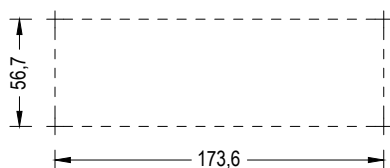
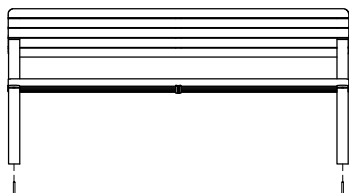

GEOMETRÍA / GEOMETRY

E:1/20

UNIVERSE-UP banco / bench

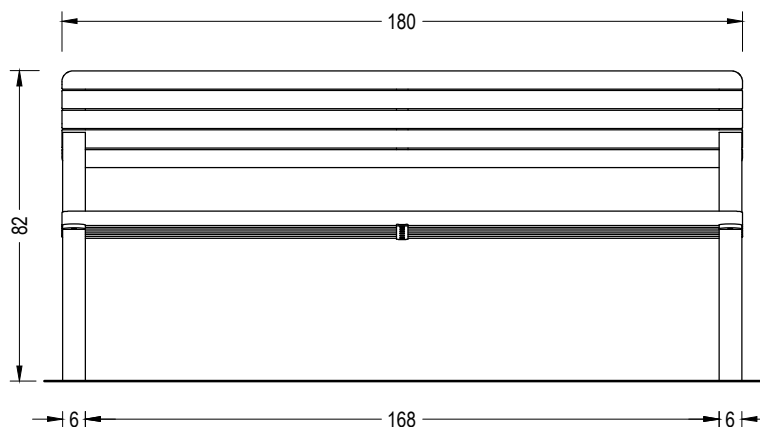

FRONTAL
 FRONT

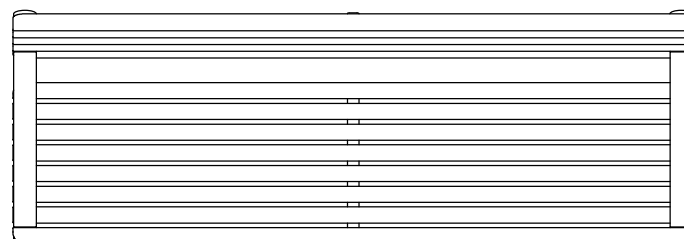

PLANTA
 TOP

UNIVERSE-UP silla / chair

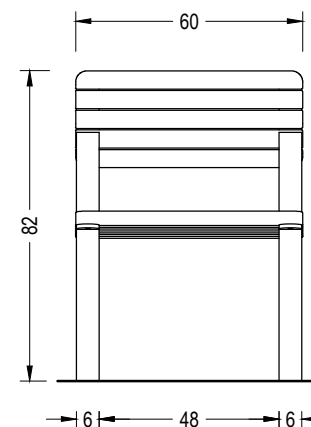

FRONTAL
 FRONT

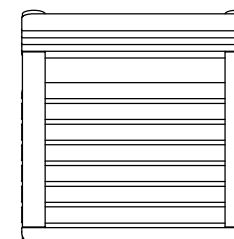

PLANTA
 TOP

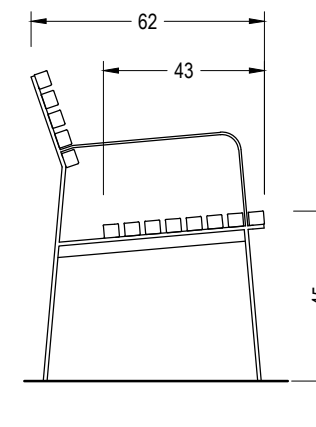

LATERAL
 SIDE

E:1/20

CARACTERÍSTICAS / CHARACTERISTICS

MATERIAL madera tropical certificada FSC®
ACABADO tratado con aceite translúcido
SOPORTES acero zincado / acero inoxidable
ACABADO pintado plata texturizado / granallado
COLOC. anclado con tornillos
PESO banco 60 kg / silla 30 kg
 banca 34 kg / taburete 17 kg
 chaise longue 60 kg / mesa 60 kg

MATERIAL tropical wood FSC® certified
FINISH treated with translucent oil
SUPPORTS zinc plated steel / stainless steel
FINISH textured silver coated / shotblasted
FIXING anchored with screws
WEIGHT bench 60 kg / chair 30 kg
 backless bench 34 kg / stool 17 kg
 chaise longue 60 kg / table 60 kg

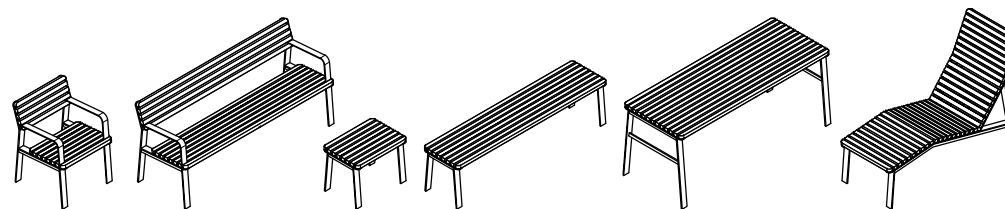

Update 21/09/2022
 Cotas / Sizes cm

INSTALACIÓN / INSTALLATION

elevación / hoisting
 P = 34 kg / 17 kg

eslingas de poliéster
 polyester slings

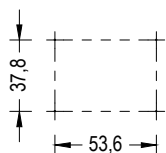
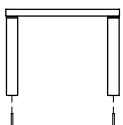

rosar 4 tornillos a fondo DIN 913 M6 x 100
 tightly screw 4 stud bolts DIN 913 M6 x 100

taladrar el pavimento Ø12 mm y llenar con resina
 drill pavement Ø12 mm and fill with resin

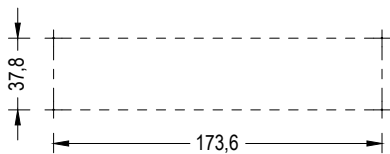
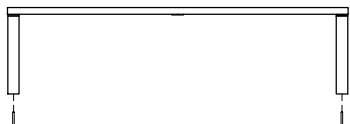

E:1/20

GEOMETRÍA / GEOMETRY

UNIVERSE-UP banca / backless bench

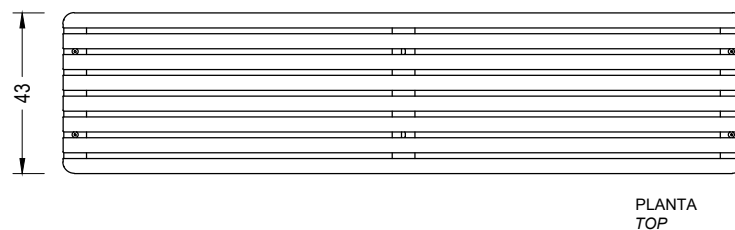
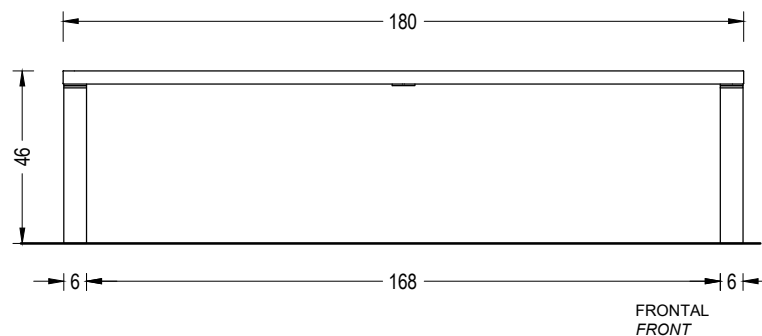

UNIVERSE-UP taburete / stool

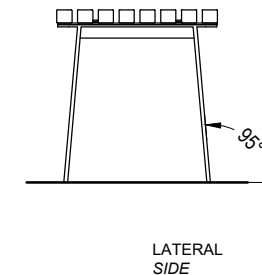
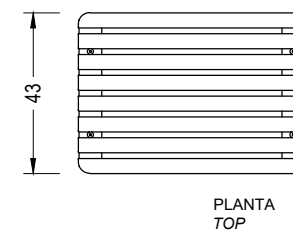
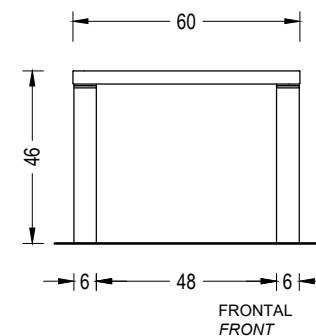

E:1/20

CARACTERÍSTICAS / CHARACTERISTICS

MATERIAL madera tropical certificada FSC®
ACABADO tratado con aceite translúcido
SOPORTES acero zincado / acero inoxidable
ACABADO pintado plata texturizado / granallado
COLOC. anclado con tornillos
PESO banco 60 kg / silla 30 kg
 banca 34 kg / taburete 17 kg
 chaise longue 60 kg / mesa 60 kg

MATERIAL tropical wood FSC® certified
FINISH treated with translucent oil
SUPPORTS zinc plated steel / stainless steel
FINISH textured silver coated / shotblasted
FIXING anchored with screws
WEIGHT bench 60 kg / chair 30 kg
 backless bench 34 kg / stool 17 kg
 chaise longue 60 kg / table 60 kg

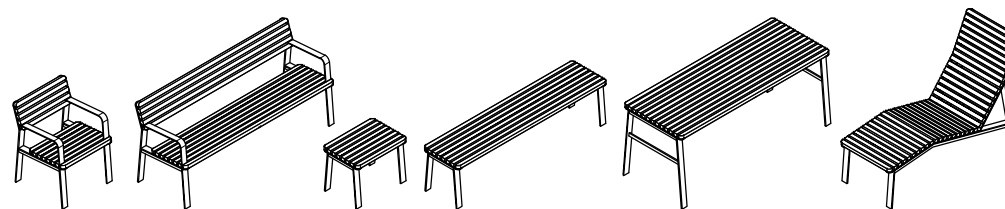

Update 21/09/2022
 Cotas / Sizes cm

INSTALACIÓN / INSTALLATION

elevación / hoisting
 P = 60 kg

eslingas de poliéster
 polyester slings

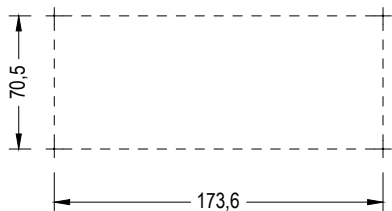
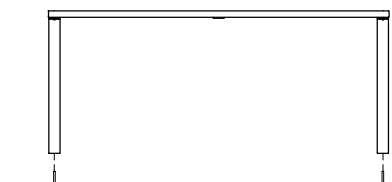

roskar 4 tornillos a fondo DIN 913 M6 x 100
 tightly screw 4 stud bolts DIN 913 M6 x 100

taladrar el pavimento Ø12 mm y llenar con resina
 drill pavement Ø12 mm and fill with resin

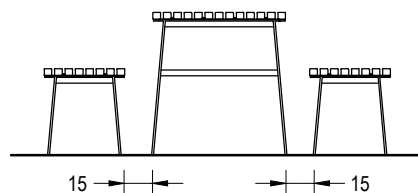

E:1/20

GEOMETRÍA / GEOMETRY

UNIVERSE-UP mesa / table

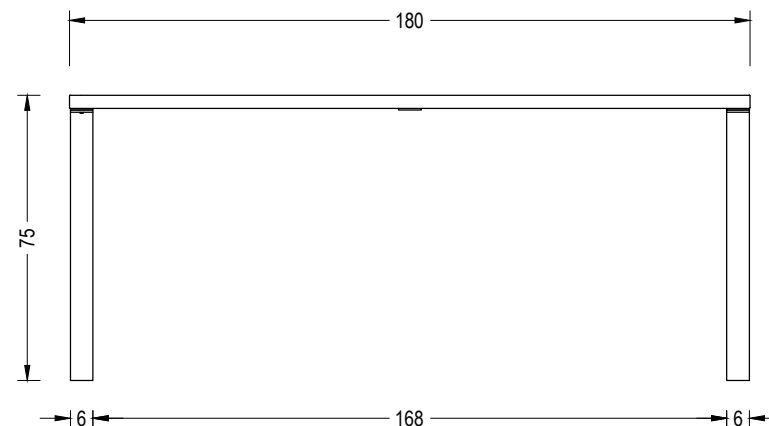

FRONTAL
 FRONT

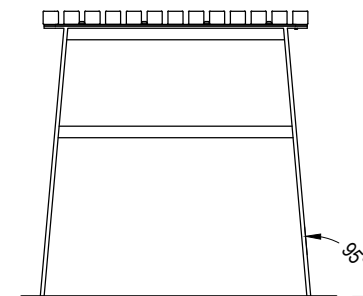

LATERAL
 SIDE

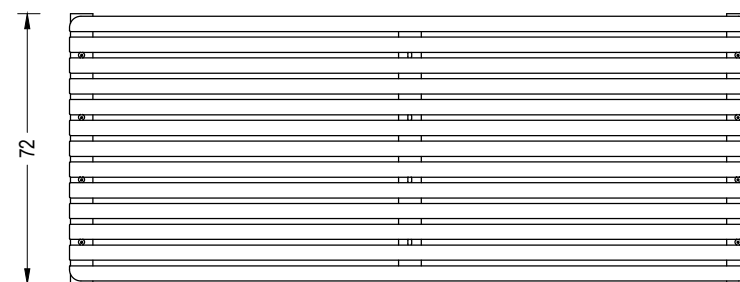

PLANTA
 TOP

E:1/20

CARACTERÍSTICAS / CHARACTERISTICS

MATERIAL madera tropical certificada FSC®
ACABADO tratado con aceite translúcido
SOPORTES acero zincado / acero inoxidable
ACABADO pintado plata texturizado / granallado
COLOC. anclado con tornillos
PESO banco 60 kg / silla 30 kg
 banca 34 kg / taburete 17 kg
 chaise longue 60 kg / mesa 60 kg

MATERIAL tropical wood FSC® certified
FINISH treated with translucent oil
SUPPORTS zinc plated steel / stainless steel
FINISH textured silver coated / shotblasted
FIXING anchored with screws
WEIGHT bench 60 kg / chair 30 kg
 backless bench 34 kg / stool 17 kg
 chaise longue 60 kg / table 60 kg

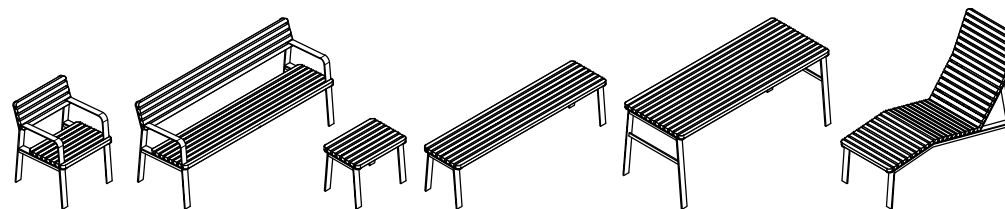

Update 21/09/2022
 Cotas / Sizes cm

INSTALACIÓN / INSTALLATION

elevación / hoisting
 P = 60 kg

eslingas de poliéster
 polyester slings

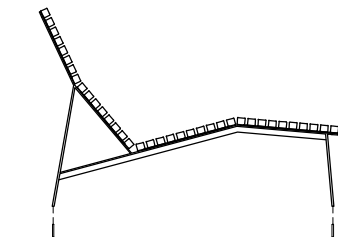

roskar 4 tornillos a fondo DIN 913 M6 x 100
 tightly screw 4 stud bolts DIN 913 M6 x 100

taladrar el pavimento Ø12 mm y llenar con resina
 drill pavement Ø12 mm and fill with resin

E:1/20

GEOMETRÍA / GEOMETRY

UNIVERSE-UP chaise longue

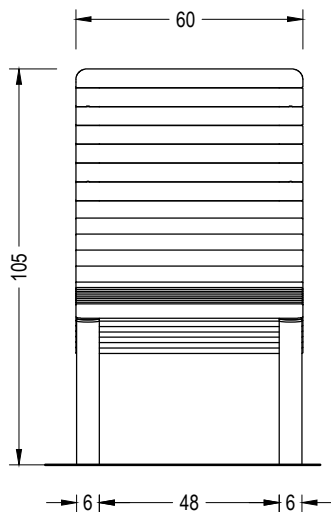

FRONTAL
 FRONT

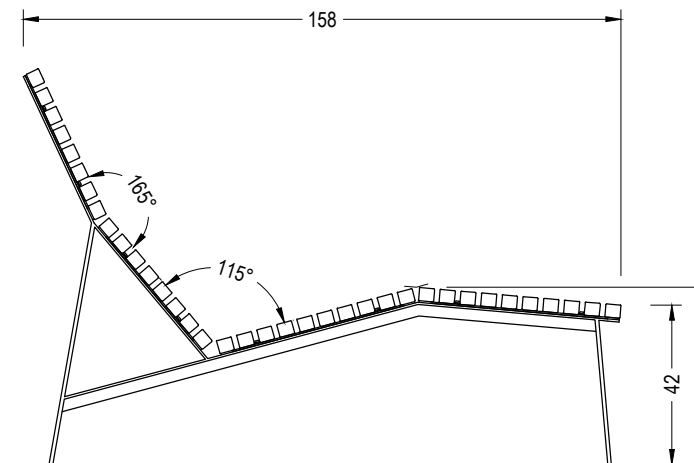

LATERAL
 SIDE

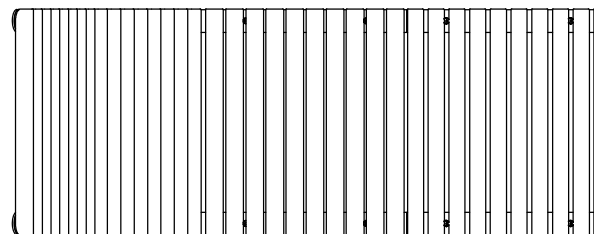

PLANTA
 TOP

E:1/20