

Villette is a singular modular bench design that stands out in its surroundings due to the light movement of its circular layout. The glass lenses embedded in the surface of the seat reflect the sunlight or light up at night. When optionally accompanied by light from the earth, giving it a buoyant effect, at night it is converted into a highly effective visual element that traces an arc of light suspended in space.

Concrete |  190 cm/max |  500 kg |  4

Add-ons: LED

 Update 26.01.2023



Origin

Villette was initially a furnishing used in a project by the Swiss architect Bernard Tschumi, who won the Parque de la Villette competition held in 1982 in the city of Paris.

Design

Its “C”-shaped cross-section has a part which rests on the foundation slab embedded beneath the paving. It has cavities for housing the optional projectors (which are not provided) embedded in the paving. The *Villette* design has been included in the collection since 1982, with up to nine new layouts with different curve radii, and a straight model.

Material

This backless bench is supplied in reinforced concrete, in the *Escofet* standard chart colour in polished and water-repellent finishes or etched and waterproofed, and with fused glass lenses embedded on the top surface of the seat. Optional inclusion of light projectors at the base which light up the bottom of the seat.

Installation

Supplied as a self-standing backless bench that rests on a slab placed beneath the paving, at a certain level in keeping with the paving thickness.





Benches may be added to form wide arcs with a constant or variable radius, for adaptation to different urban situations.



1. Modular

Villette	Recto	Curvos
Dimensions	190 x 50 x 42 (60)cm	according to model
Weight	500 kg	500 kg
1.1 General features		
Material	Reinforced concrete Glass lenses	Fixing Embedded in the pavement
Finish	Etched and waterproofed / Polished and waterproofed	

Colours



GR. Grey
GR P. Polished Grey

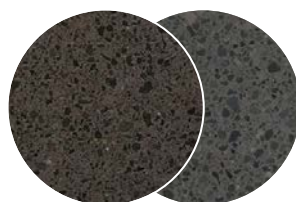

NG. Black
NG P. Polished Black

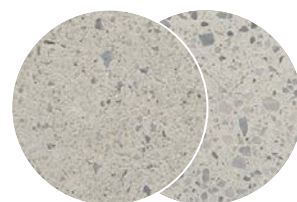

BL. White
BL P. Polished White

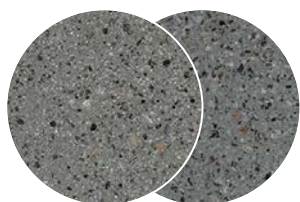

CA. CA Grey
CA P. Polished CA Grey

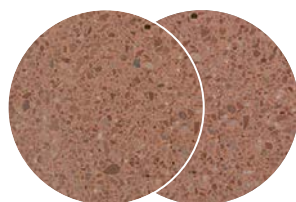

RA. Red
RA P. Polished Red

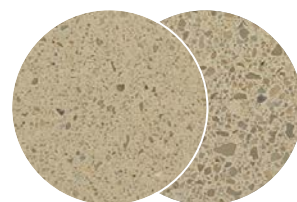

BG. Beige
BG P. Polished Beige

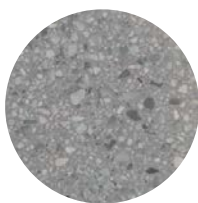

GB P. Polished Grey-White



A. Glass lenses

1.2 Installation system

Hoisting

(P=500 kg)

Installation

Prepare ground as graphic.
Place a base with blocks
of leveling and concreting.

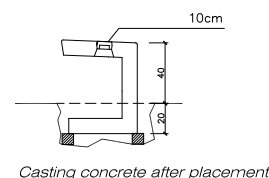
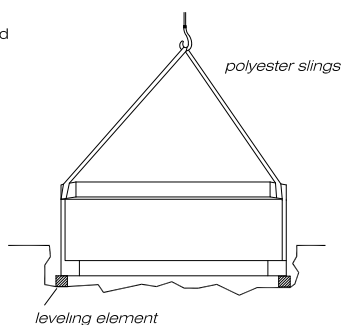
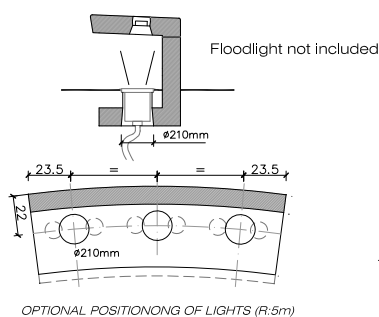

1.3 Geometría

Villette

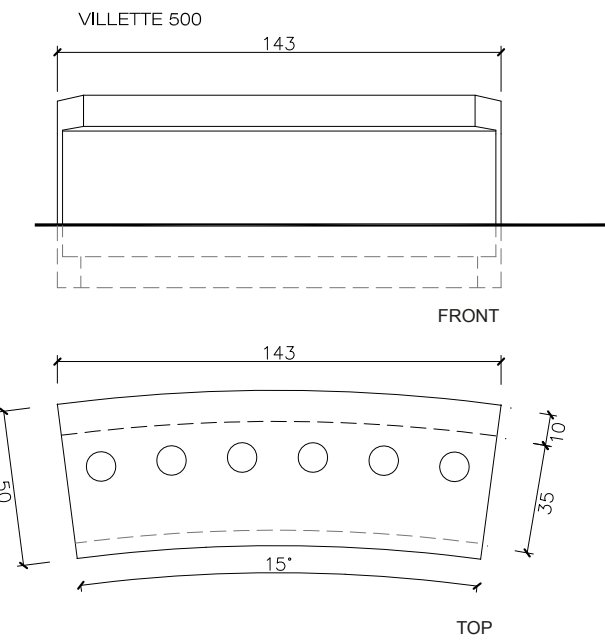
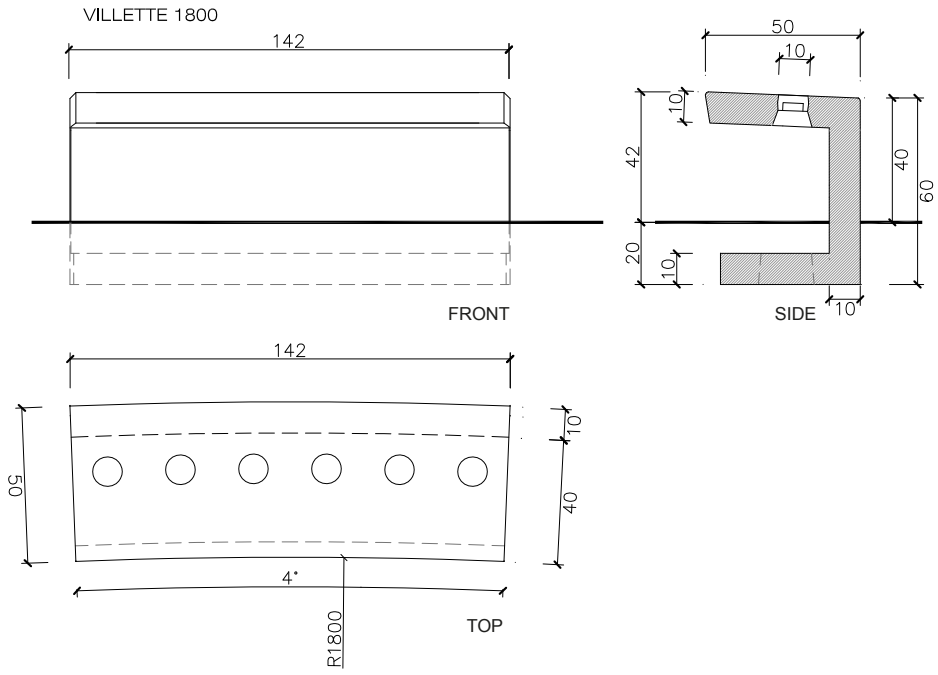

Aggregation

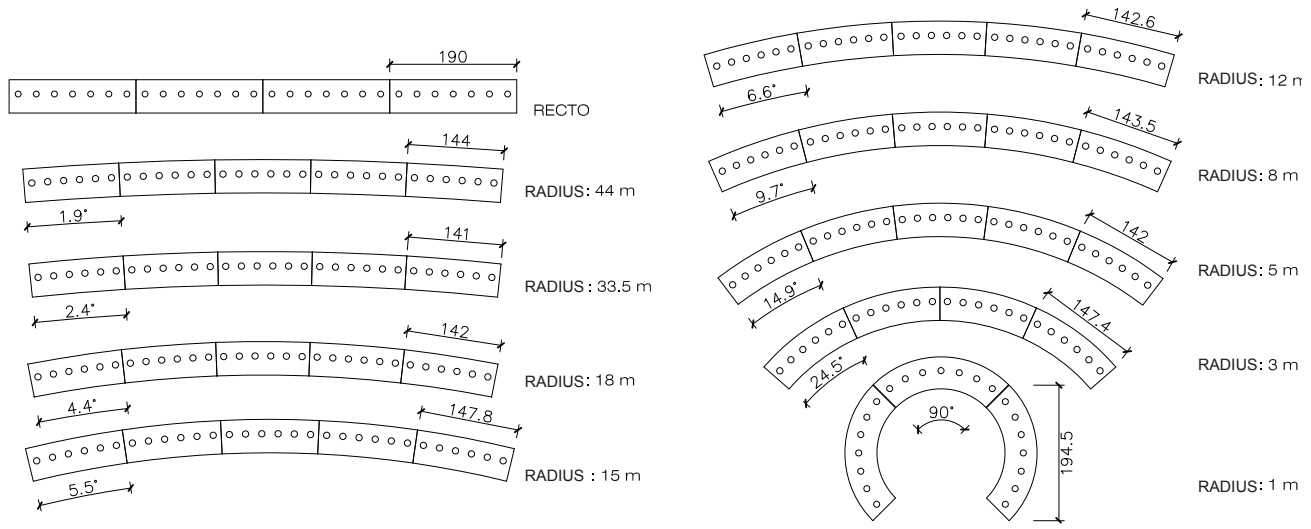

VILLETTE

Escofet

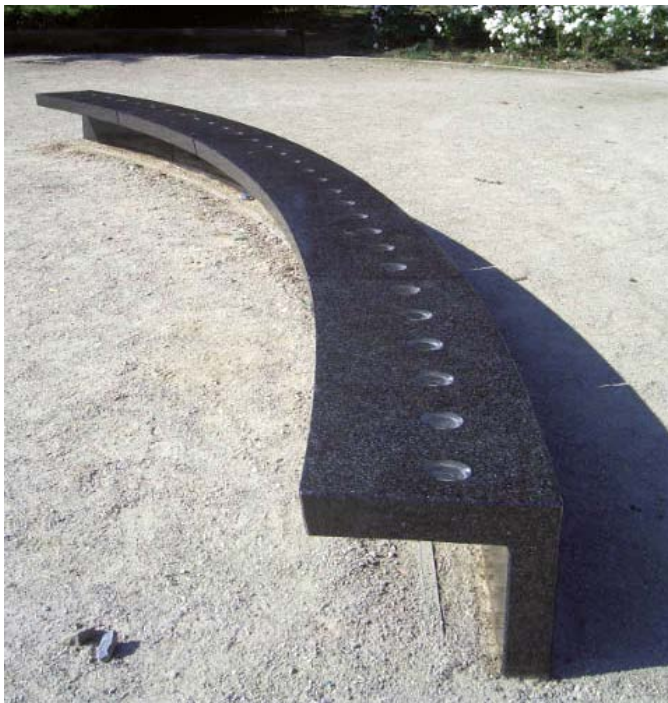

Warranty

5 years in concrete elements.

The names, trademarks and industrial models of the products have been logged in the corresponding registers. The technical information provided by Escofet about its products can be modified without prior notice.

Escofet 1886 S.A
Head office and production

Montserrat, 162
E 08760 Martorell
Barcelona - España
T. 0034 937 737 150
F. 0034 937 737 151

info@escofet.com
www.escofet.com



GA-2005/0072 SST-0090/2010 ER-0403/2016