

The SOC urban elements are used as seats, borders and also as group reference points, generating meeting places or linear arrangements and highlighting routes. They also serve as isolated elements to indicate specific sites. They have an optional LED light in their entire perimeter.

Hormigón | LED | Ø 120 cm/max | ⚖ 1081 kg | 📏 3

🔄 Update 30.07.2025



## CONTEMPORARY

Their simple yet robust design, combined with the lighting option and the finish colour, make them extremely versatile products for universal use in urban settings.

## DESIGN

The collection is presented with six models of different diameters: 120, 90 and 60 cm resting on the ground with a recessed socket that enhances its volume. On the one hand, the three Monobloc models, made of a single piece of concrete. And on the other hand, the three elements with upper concrete lid that it incorporates LED light, which surrounds its entire perimeter, generating a levitation effect at night. Their geometry, weight and shock resistance make them the perfect dissuasive element that is ideal for creating boundaries.

## MATERIAL

Stool made from reinforced, etched, water-repellent concrete in the Escofet standard colour chart.

## INSTALLATION

The round concrete cover makes it possible to inspect the Driver and LED strip. Fastened to the paving with three M12 screws.





# SOC



**Escofet**  
by Molins<sup>®</sup>

1. Backless benches

Soc	60	90	120
Dimensions	Ø60 x 45	Ø90 x 45	Ø120 x 45
Weight	224 kg	550 kg	1081 kg
Lighting	LED 6 W; 4000°K o 3000°K	LED 10 W; 4000°K o 3000°K	LED 12 W; 4000°K o 3000°K
Driver	24V / IP67		

Soc Monobloc	60 Monobloc	90 Monobloc	120 Monobloc
Dimensions	Ø60 x 45	Ø90 x 45	Ø120 x 45
Weight	300 kg	565 kg	892 kg

1.1 General features

Material	Concrete Recycled Concrete	Fixing	Anchored with screws
----------	-------------------------------	--------	----------------------

Finish	Etched and waterproofed
--------	-------------------------

Colours			
	GR. Grey	NG. Black	BL. White
			
	CA. CA Grey	RA. Red	BG. Beige
			
	EGR. Eco-Grey®		

## 1.2 Installation system

Hoisting  
(P=224 / 550 / 1081 kg)

Installation  
Tightly screw 3 stud bolts (M12 x 140).  
Drill pavement fill with resin or fat mortar

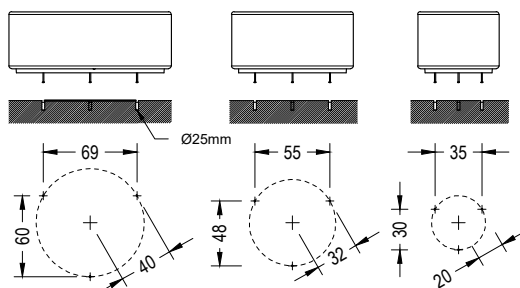
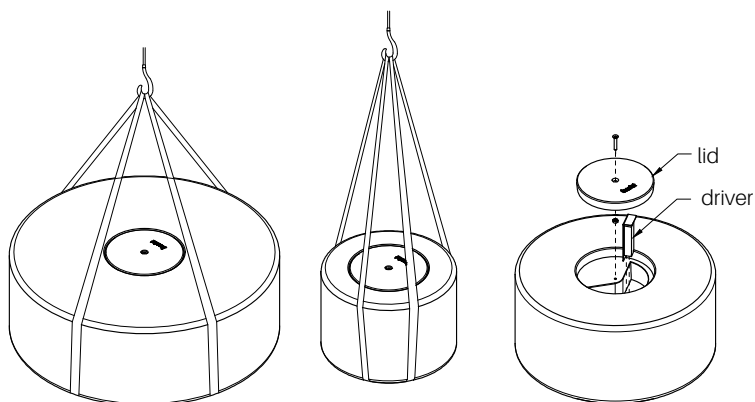

Hoisting  
(P= 300 / 565 / 892 kg)

Installation  
Tightly screw 3 stud bolts (M12 x 140).  
Drill pavement fill with resin or fat mortar

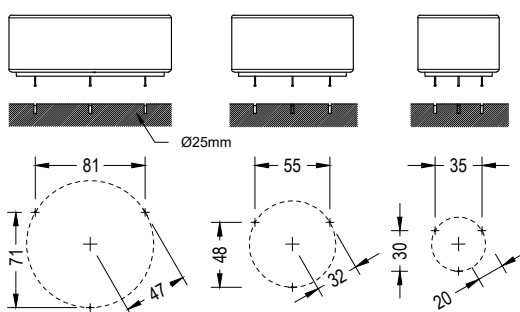
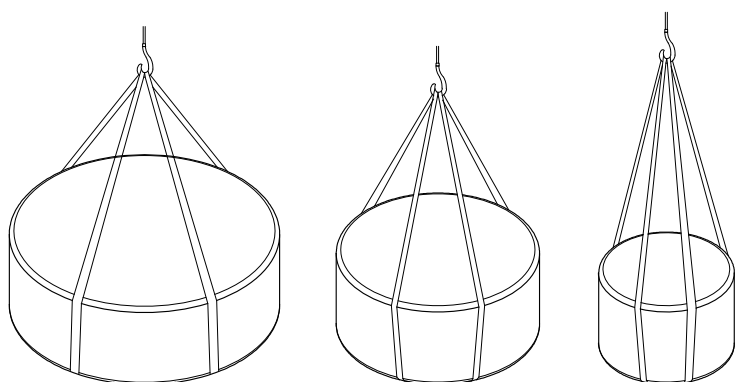

Soc 90

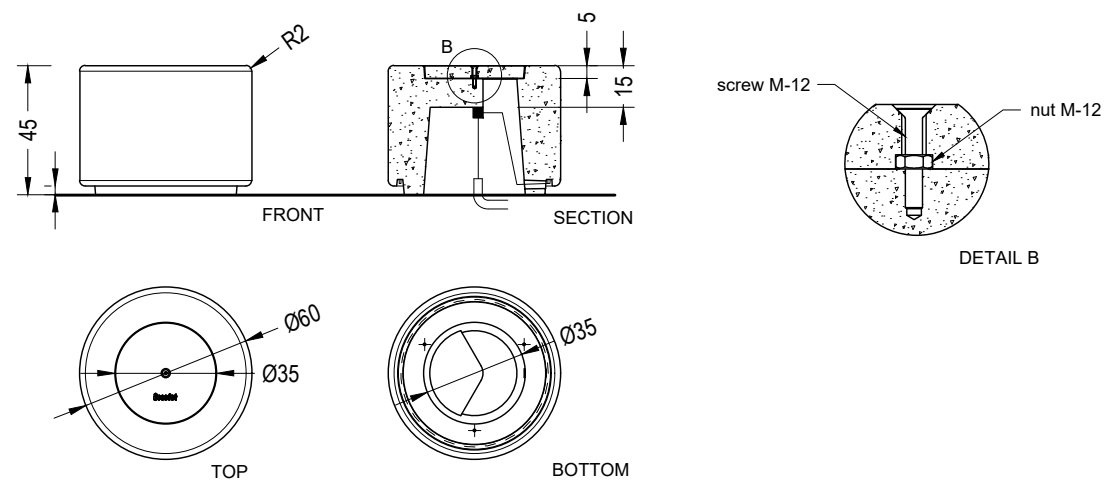

Soc 90

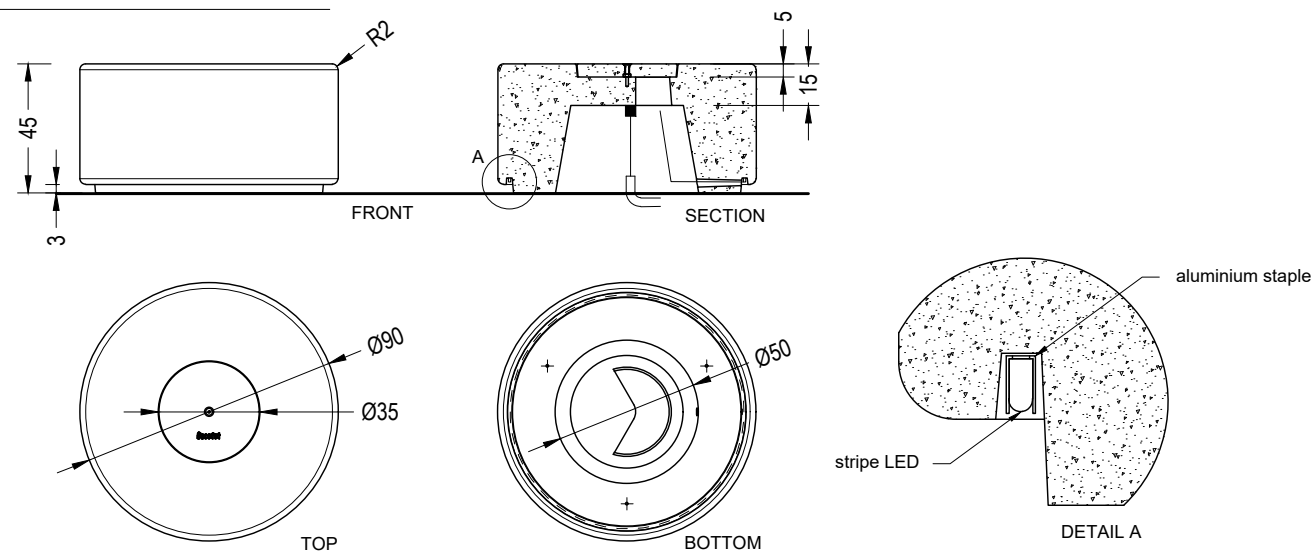

Soc 120

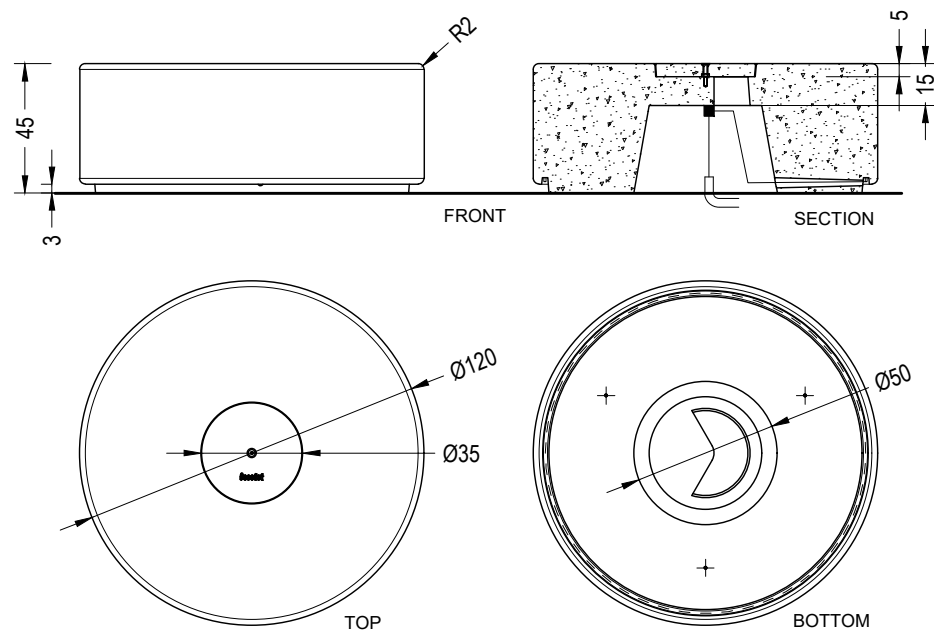

Soc 90 Monobloc

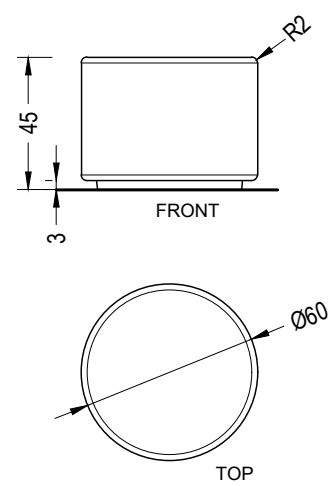

Soc 90 Monobloc

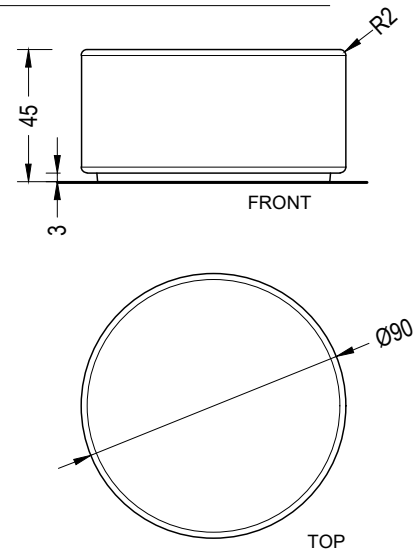

Soc 120 Monobloc

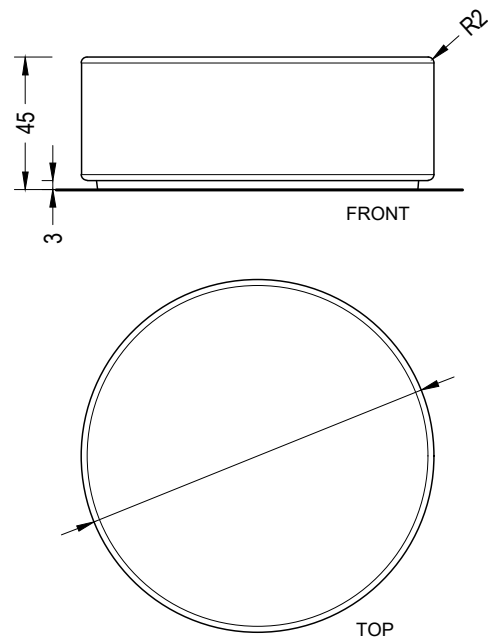



### Warranty

5 years in concrete elements.

The names, trademarks and industrial models of the products have been logged in the corresponding registers. The technical information provided by Escofet about its products can be modified without prior notice.

Escofet 1886 S.A  
Head office and production

Montserrat, 162  
E 08760 Martorell  
Barcelona - España  
T. 0034 937 737 150  
F. 0034 937 737 151

info@escofet.com  
www.escofet.com

**Escofet**  
by Molins<sup>®</sup>

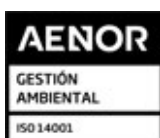

GA-2005/0072



SST-0090/2010



ER-0403/2016

